

RPL IS HELD TO THE BRACES BY TAPERED SCREWS WHICH ARE DRIVEN INTO THE RPL FROM THE BACK AND BOTTOM AND ARE NOT VISIBLE FROM ABOVE. McMASTER #95638A317 PIN-IN-TORX TAMPER RESIST SHEET METAL SCREW 18-8 STAINLESS STEEL, BUTTON HEAD, NO 14 SIZE, 1-1/2" LENGTH NOT VISIBLE FROM FRONT OF BENCH.

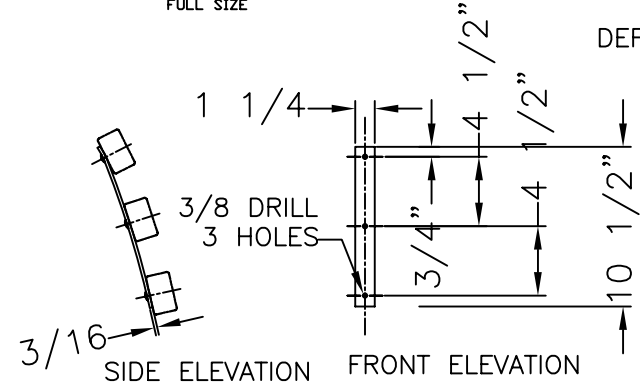

MAT'L: 3/16" x 1 1/4" HRS BACK BRACE FOR RPL SLATS

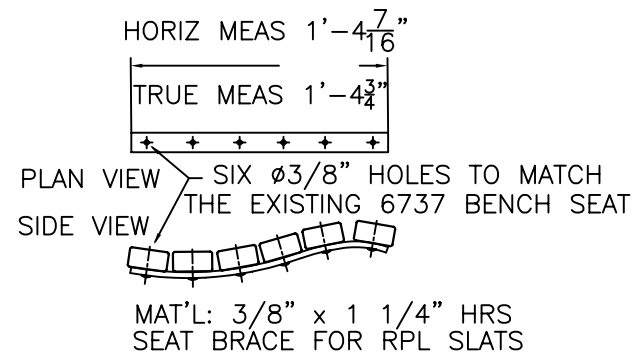

MAT'L: 3/8" x 1 1/4" HRS SEAT BRACE FOR RPL SLATS

NOTE: THIS DRAWING VARIES FROM STANDARD IN THAT THE DISTANCE FROM THE EDGE OF THE SLATS TO THE CENTER OF THE LEG IS 3 INCHES.

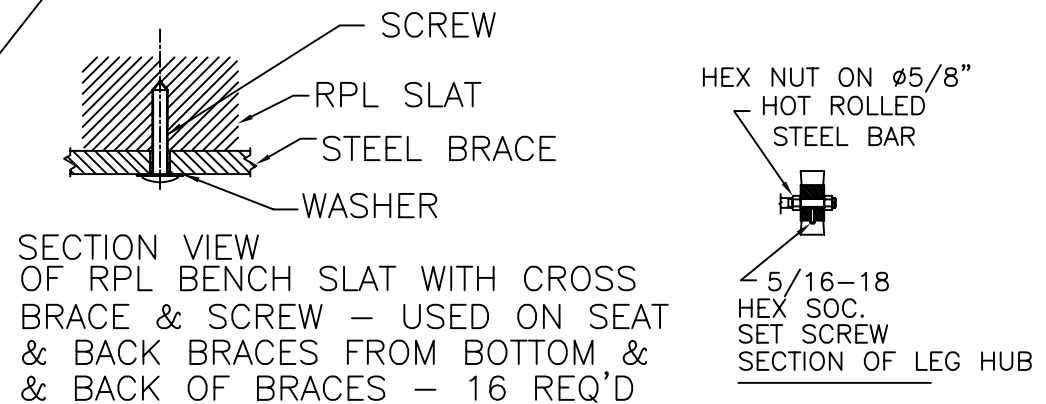
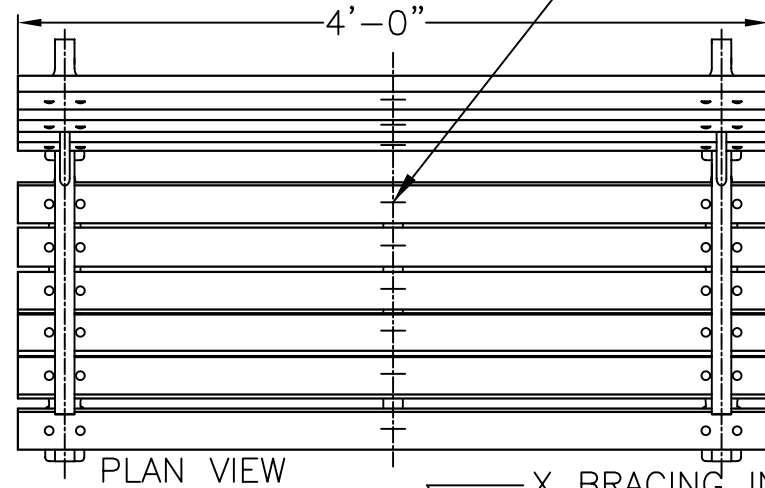

SECTION VIEW OF RPL BENCH SLAT WITH CROSS BRACE & SCREW - USED ON SEAT & BACK BRACES FROM BOTTOM & BACK OF BRACES - 16 REQ'D

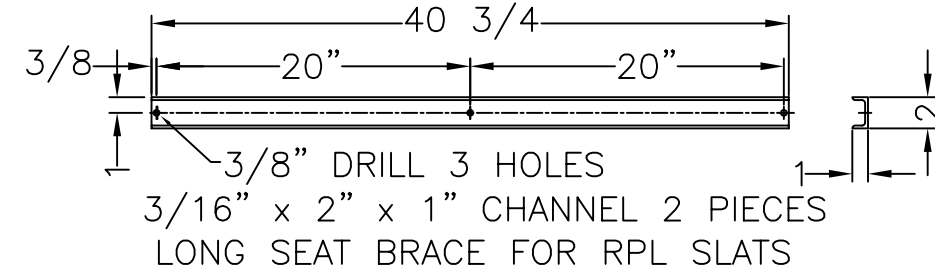

3/16" x 2" x 1" CHANNEL 2 PIECES LONG SEAT BRACE FOR RPL SLATS

COLOR:

RPL _____
CI & STEEL: BLACK

MATERIALS:

X-BRACING: 3/16" X 1 1/4" HOT ROLLED STEEL
BENCH LEGS: CAST DUCTILE IRON
BENCH SLATS: RPL (RECYCLED PLASTIC LUMBER)
SMALL FASTENERS (CARRIAGE BOLTS, NUTS AND WASHERS), STAINLESS STEEL
TIE ROD: 5/8" DIA HOT ROLLED STEEL WITH 5/8 - 11 CUT THREADS & STEEL HEX NUTS
BRACES FOR RPL: 3/8" x 1 1/4" HRS

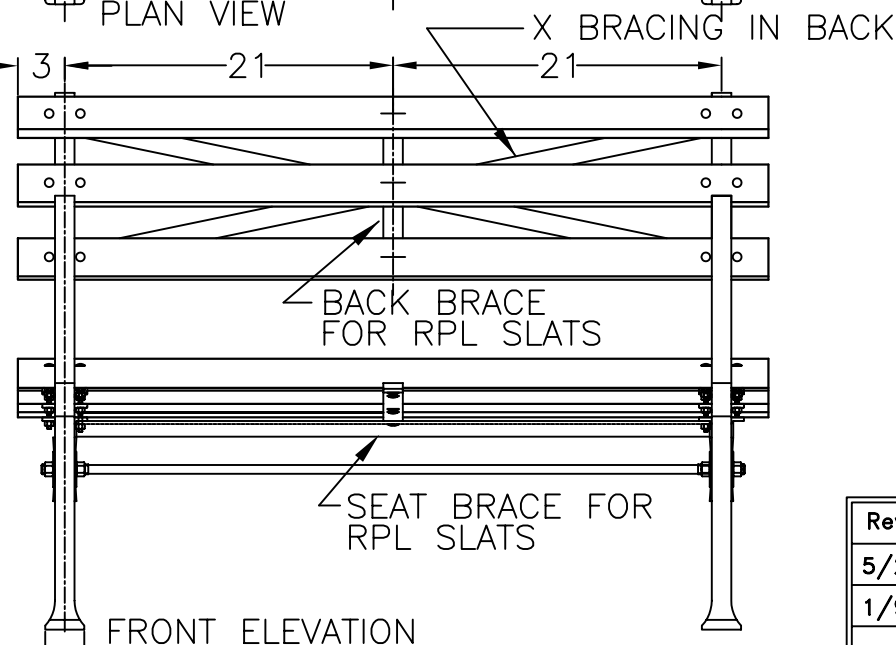
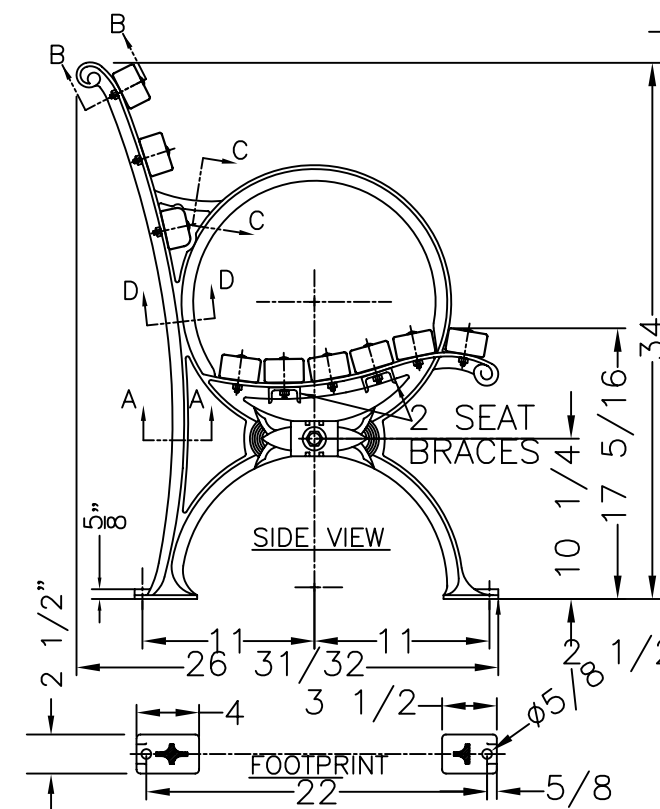

WHEN USED, ANCHOR BOLTS ARE TO BE INSTALLED IN EACH FOOT OF EACH LEG.

KENNETH LYNCH & SONS

114 WILLENBROCK ROAD OXFORD, CT 06478
PHONE 203-264-2831 FAX 203-264-2833

Revised:	Dr. By:
5/2/11	S.L.A.
1/9/12	S.L.A.

6737 WORLDS FAIR BENCH		
Scale FAX	Date 4/2/09	Drawn S.L.A.
RECYCLED PLASTIC SLATS		4' LONG
MAT'L: AS NOTED	CONTRACT #	
#6737-4-RPL-FX-2012 NYC		